

Data sheet

Support roller NA 2204.2RS (crowned, with seal and inner ring)

Designation	NA 2204.2RS
Type	crowned
D [mm]	47
d [mm]	20
F, Fw * [mm max.]	25
B1 [mm]	18
B [mm]	17,8
r [mm]	1
r1 [mm]	0,3
Dynamic load Crw[N]	15200

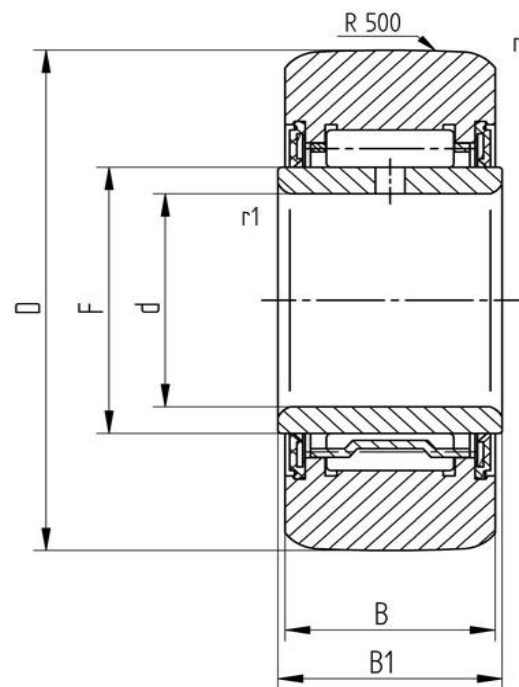

Every specification has been edited and verified carefully. STI Bearings GmbH assumes no liability for potential errors or incompleteness. Technical modifications are subject of changes.

© 2020 by STI Bearings GmbH
 Reproduction, even excerpts, only with our approval.